

General Purpose Worm Drive Clamps

H Series – With Zinc Plated Carbon Steel Screw

Band and housing are 200/300 series stainless steel. Screw is 5/16" slotted hex head, heat treated carbon steel, double plated with zinc plus trivalent chromate for long lasting protection. Good general-purpose clamp.

HSS Series – With "400" Series Steel Screw Clamps

Band and housing are 200/300 series stainless steel. Screw is 5/16" slotted hex head, heat treated 400 series stainless steel. The high corrosion resistance of this all stainless steel band, housing and screw makes this the perfect clamp for numerous industrial installations.

HFSS Series – All "300" Series Stainless Steel Clamps

Band, housing and screw are 300 series stainless steel. Screw is 5/16" slotted hex head. The all-300 series stainless steel construction provides better corrosion resistance than that available from the "H-SS" Series, making this worm drive clamp well suited for marine applications.



Specifications

Clamp Size Chart

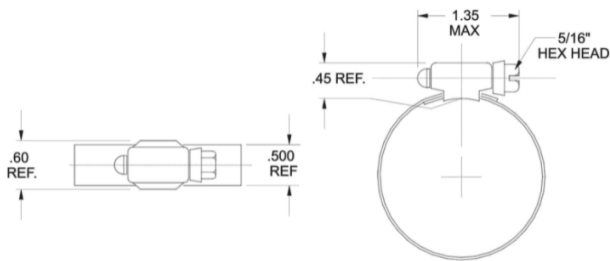

Applies to: H, H-SS, HF-SS, HL-SS Series

Clamp Series SAE Size	"A" Diameter Range					
	Decimals		Inches		Millimeters	
6	0.44	0.78	7/16	25/32	11	20
8	0.44	0.91	7/16	29/32	11	23
10	0.56	1.06	9/16	1 1/16	14	27
12	0.69	1.25	11/16	1 1/4	18	32
16	0.75	1.5	3/4	1 1/2	19	38
20	0.81	1.75	13/16	1 3/4	21	44
24	1.06	2	1 1/16	2	27	51
28	1.31	2.25	1 5/16	2 1/4	33	57
32	1.56	2.5	1 9/16	2 1/2	40	64
36	1.81	2.75	1 13/16	2 3/4	46	70
40	2.06	3	2 1/16	3	52	76
44	2.31	3.25	2 5/16	3 1/4	59	83
48	2.56	3.5	2 9/16	3 1/2	65	89
52	2.81	3.75	2 13/16	3 3/4	71	95
56	3.06	4	3 1/16	4	78	102
60	3.31	4.25	3 5/16	4 1/4	84	108
64	3.56	4.5	3 9/16	4 1/2	90	114
72	4.06	5	4 1/16	5	103	127
80*	4.56	5.5	4 9/16	5 1/2	116	140
88*	5.06	6	5 1/16	6	129	152
96	5.56	6.5	5 9/16	6 1/2	141	165
104	6.06	7	6 1/16	7	154	178