

GUARDIAN Flexible Curved Jaw Couplings

For the Mechanical Power Transmission Industry

- Zero/Low Backlash Jaw Style
- Aluminum, Cast Iron, Steel, Stainless Steel hubs
- Variable Durometer Urethane Elements
- Bore Sizes 1/8" to 6"
- Rated up to 2,000 HP

Design Characteristics

Operating Temperature -40°F to 212°F

Short Duration Maximum Temperature 250°F

Polyurethane spiders available in three hardness levels:

80 Shore A - Torsionally Soft, Blue (Not Stocked)

92 Shore A - Standard, White

98 Shore A - Torsionally Stiff, Red

Resistant to oils, grease and many solvents.

Good atmospheric and chemical resistance.

Excellent shock and vibration damping properties.

Hub jaws have unique concave pocket that eliminates edge pressures and allows prolonged wear resistance of the elastomeric spider.

Hubs can be arranged as either: Hub A Hub B, Hub B Hub B, or Hub A Hub A



Size	Hub Material	Insert	Min / Max Bore A Hub B Hub	KW @ 1400 rpm	Std Torque Kg/m	Max Torque Kg/m	Max RPM	Weight Kgs
19/24	Aluminium	White Red	0/19 17/ 24	1.46 2.33	1.00 1.707	2.018 3.402	14000	.126
24/32	Sintered Steel	White Red	0/24 7/32	5.15 8.74	3.517 6.00	7.03 12.00	10600	.324
28/38	Sintered Steel	White Red	0/28 10/38	13.94 23.33	9.51 16.03	19.03 32.06	8500	.657
38/45	Cast Iron	White Red	0/38 36/45	27.9 47.25	19.03 32.53	38.06 65.05	7100	2.25
42/55	Cast Iron	White Red	0/42 40/ 55	38.5 65.93	26.52 44.98	53.05 89.96	6000	3.541
48/60	Cast Iron	White Red	0/48 46/60	44.92 77	31.14 52.59	62.28 106.1	5600	4.761
55/70	Cast Iron	White Red	0/55 53/70	54.83 91.7	37.40 62.57	76.12 125.14	4750	7.312

Coupling Dimensions

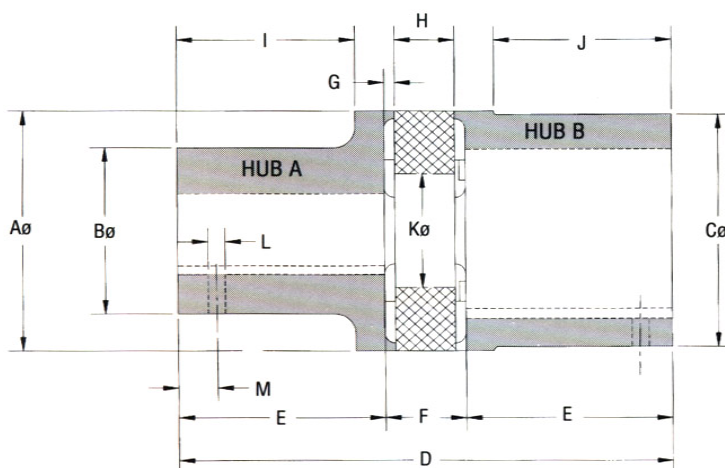

Size	A	B	C	D	E	F	G	H	I	J	K	L	M
19/24	40	32	25.4	66	25	16	2	12	20	21	18	N/A	N/A
24/32	54	54	54	78	30	18	2	14	N/A	N/A	27	N/A	N/A
28/38	65	65	65	90	35	20	2.5	15	N/A	N/A	30	N/A	N/A
38/45	80	66	77	114	45	24	3	18	37	37	38	N/A	N/A
42/55	95	75	94	126	50	26	3	20	40	40	46	N/A	N/A
48/60	105	85	102	140	56	28	3.5	21	45	45	51	N/A	N/A
55/70	120	98	118	160	65	30	4	22	52	52	60	N/A	N/A