

IDLER DIMENSIONAL CHARTS 62 SERIES



SERIES A25-62 ROLLER DIA.114 BEARING 6205

3 ROLL OFFSET TROUGH/IMPACT IDLERS

MAX. BELT SPEED 4.5 m/s

BROACHING PLAIN 14.3 A/F

BEARING RATING 1430 kg

BROACHING IMPACT 14.3 A/F

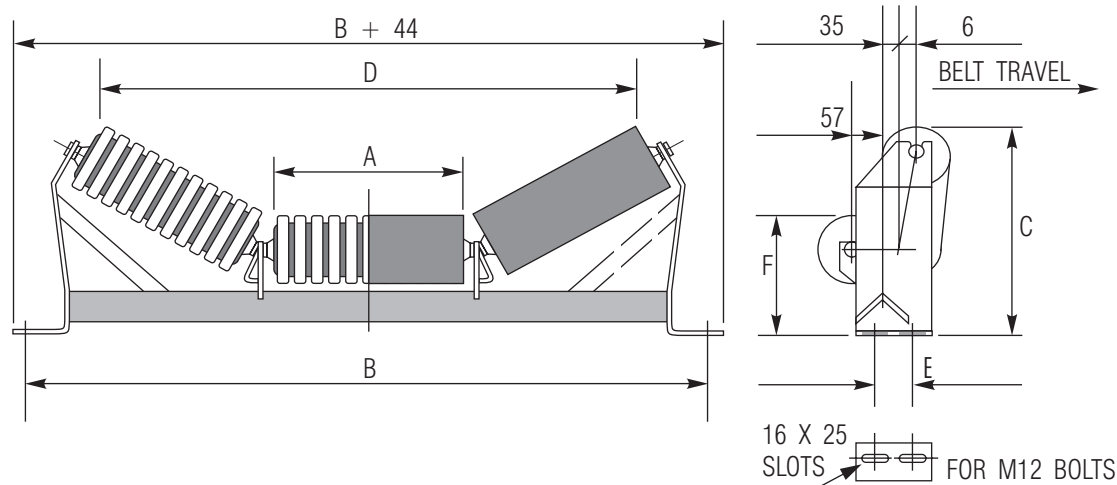

IDLER DIMENSIONS mm													ANGLE SIZE	SHAFT DIA
BELT WIDTH	A	B	20°		30°		35°		45°		E	F		
			C	D	C	D	C	D	C	D				
400	154	650	234	497	259	433	268	410	291	382	56	179	65	27
450	172	700	240	549	268	482	278	457	304	426	56	179	65	27
500	189	750	246	598	276	528	288	502	316	467	56	179	65	27
600	224	850	258	698	294	624	308	594	341	551	56	179	65	27
650	244	900	265	756	304	679	319	647	355	600	56	179	65	27
750	278	1000	277	854	321	771	339	737	379	682	56	179	65	27
800	294	1050	282	900	329	815	348	779	390	720	56	179	65	27
900	331	1150	295	1006	347	916	369	877	417	810	56	179	75	27
1000	358	1250	304	1084	361	990	385	948	436	875	56	179	75	27
1050	383	1300	312	1156	373	1058	399	1014	453	935	56	179	75	27
1200	436	1450	331	1309	400	1203	430	1154	491	1063	56	179	75	27

IDLER SETS MASSES				
BELT WIDTH	PLAIN		IMPACT	
	MRP	TOTAL	MRP	TOTAL
400	6.9	17.4	7.0	17.6
450	7.4	18.5	7.4	18.5
500	7.9	19.5	8.3	19.9
600	9.0	21.7	9.5	22.3
650	9.5	22.9	10.4	23.9
750	10.5	26.3	12.2	28.0
800	11.0	27.4	12.5	28.9
900	12.1	29.8	14.3	32.0
1000	12.9	32.8	15.4	35.3
1050	13.6	34.3	16.4	37.2
1200	15.2	37.9	18.6	41.4

UNIT MASSES		
FRAME	MASS 1 ROLL	
ONLY	PLAIN	IMPACT
7.2	3.4	3.5
7.5	3.7	3.7
7.8	3.9	4.0
8.5	4.4	4.6
8.8	4.7	5.0
10.7	5.2	5.7
11.1	5.4	5.9
11.9	5.9	6.7
13.8	6.3	7.2
14.3	6.7	7.6
15.6	7.4	8.6

IDLER DIMENSIONAL CHARTS 62 SERIES



SERIES A30-62 ROLLER DIA.114 BEARING 6206

3 ROLL OFFSET TROUGH IDLERS

MAX. BELT SPEED 4.5 m/s

BROACHING PLAIN 14.3 A/F

BEARING RATING 1980 kg

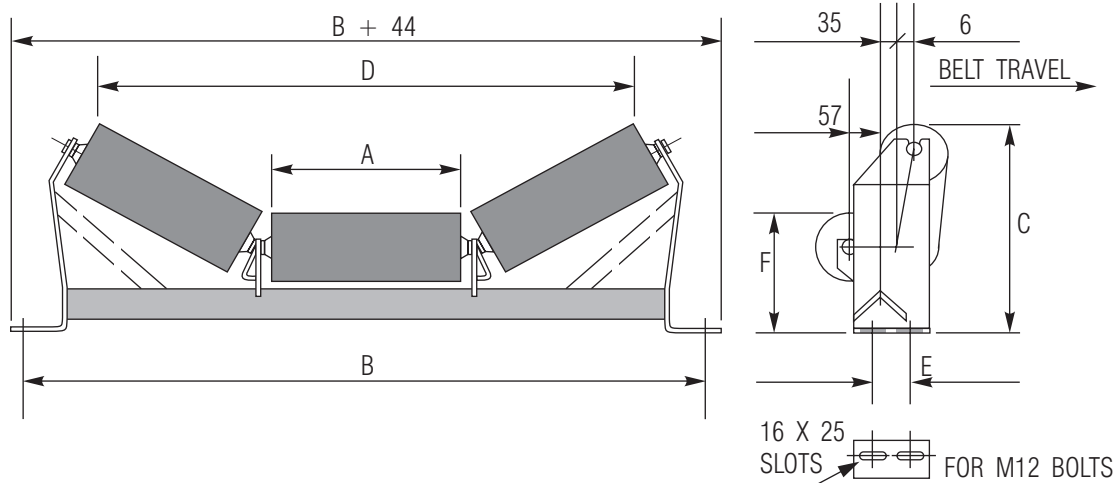

	IDLER DIMENSIONS mm													
BELT WIDTH	A	B	20°		30°		35°		45°		E	F	ANGLE SIZE	SHAFT DIA
			C	D	C	D	C	D	C	D				
400	154	650	236	495	260	430	270	408	292	379	56	181	65	33
450	172	700	242	547	269	479	280	455	305	422	56	181	65	33
500	189	750	248	596	277	526	290	500	317	463	56	181	65	33
600	224	850	260	696	295	621	310	592	342	548	56	181	65	33
650	244	900	267	754	305	676	321	645	356	596	56	181	65	33
750	278	1000	279	852	322	769	341	735	380	678	56	181	65	33
800	294	1050	284	898	330	813	350	777	391	717	56	181	65	33
900	331	1150	297	1005	348	914	371	875	418	806	56	181	75	33
1000	358	1250	306	1082	362	988	387	946	437	871	56	181	75	33
1050	383	1300	314	1154	374	1056	401	1012	454	932	56	181	75	33
1200	436	1450	333	1307	401	1201	432	1152	492	1060	56	181	75	33
1350	488	1650	350	1457	427	1343	461	1289	529	1185	56	181	75	33
1400	494	1700	352	1474	430	1359	465	1305	533	1200	56	181	75	33
1500	541	1800	369	1609	453	1488	492	1429	566	1313	56	181	75	33

BELT WIDTH	IDLER SETS MASSES			
	PLAIN		IMPACT	
	MRP	TOTAL	MRP	TOTAL
400	7.7	20.4		
450	8.2	21.7		
500	8.7	22.9		
600	9.8	25.4		
650	10.4	26.8		
750	11.4	29.2		
800	11.8	30.4		
900	12.9	33.9		
1000	13.7	36.1		
1050	14.5	37.8		
1200	16.0	41.7		
1350	17.6	47.5		
1400	17.7	48.2		
1500	19.1	51.5		

UNIT MASSES		
FRAME	MASS 1 ROLL	
ONLY	PLAIN	IMPACT
8.0	4.1	
8.4	4.4	
8.8	4.7	
9.6	5.3	
10.0	5.6	
10.8	6.1	
11.1	6.4	
12.9	7.0	
13.8	7.4	
14.3	7.8	
15.6	8.7	
18.9	9.5	
19.3	9.6	
20.4	10.4	

IDLER DIMENSIONAL CHARTS 62 SERIES



SERIES B20-62 ROLLER DIA.127 BEARING 6204

3 ROLL OFFSET TROUGH IDLERS

MAX. BELT SPEED 5 m/s

BROACHING PLAIN 14.3 A/F

BEARING RATING 1300 kg

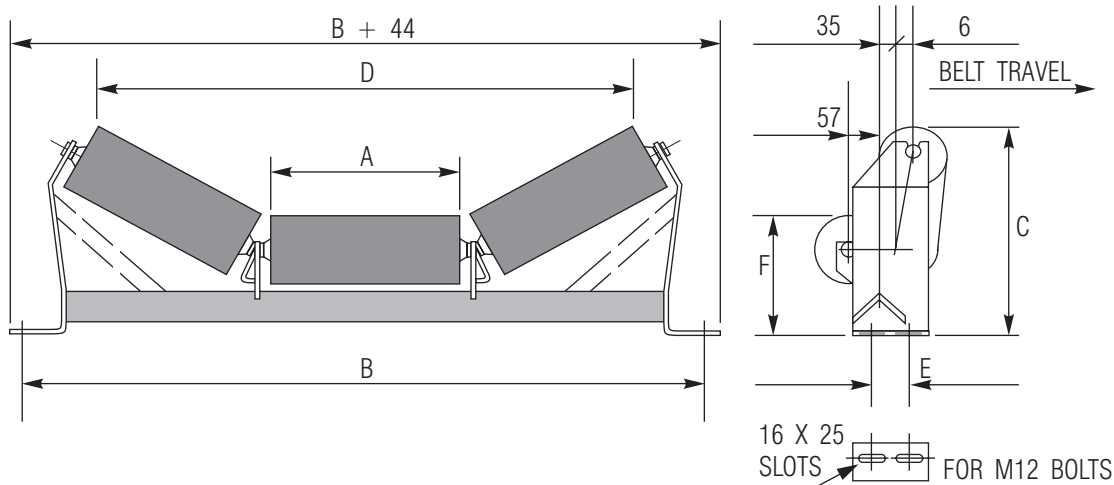

		IDLER DIMENSIONS mm												
BELT WIDTH	A	B	20°		30°		35°		45°		E	F	ANGLE SIZE	SHAFT DIA
			C	D	C	D	C	D	C	D				
400	154	650	238	494	262	429	271	405	294	377	56	183	65	24
450	172	700	244	546	271	478	281	452	307	420	56	183	65	24
500	189	750	250	595	279	524	291	497	319	461	56	183	65	24
600	224	850	262	696	297	620	311	589	344	546	56	183	65	24
650	244	900	269	753	307	675	322	642	358	594	56	183	65	24
750	278	1000	281	851	324	768	342	732	382	676	56	183	65	24
800	294	1050	286	897	332	811	351	774	393	715	56	183	65	24
900	331	1150	299	1004	350	912	372	872	420	804	56	183	75	24
1000	358	1250	308	1082	364	986	388	943	439	869	56	183	75	24
1050	383	1300	316	1154	376	1054	402	1009	456	930	56	183	75	24
1200	436	1450	335	1306	403	1199	433	1149	494	1058	56	183	75	24

IDLER SETS MASSES				
BELT WIDTH	PLAIN		IMPACT	
	MRP	TOTAL	MRP	TOTAL
400	7.4	17.2		
450	8.0	18.3		
500	8.6	19.4		
600	9.7	21.6		
650	10.4	22.8		
750	11.5	26.2		
800	12.0	27.3		
900	13.2	29.7		
1000	14.1	32.7		
1050	15.0	34.3		
1200	16.7	38.0		

UNIT MASSES		
FRAME	MASS 1 ROLL	
ONLY	PLAIN	IMPACT
7.2	3.3	
7.5	3.6	
7.8	3.8	
8.5	4.4	
8.8	4.6	
10.8	5.1	
11.2	5.4	
12.0	5.9	
13.8	6.3	
14.3	6.7	
15.6	7.4	

IDLER DIMENSIONAL CHARTS 62/82 SERIES



SERIES A25-62/82 ROLLER DIA.114 BEARING 6205

SERIES A30-62/82 ROLLER DIA.114 BEARING 6206

FLAT RETURN & CARRY IDLERS

BROACHING PLAIN 14.3 A/F

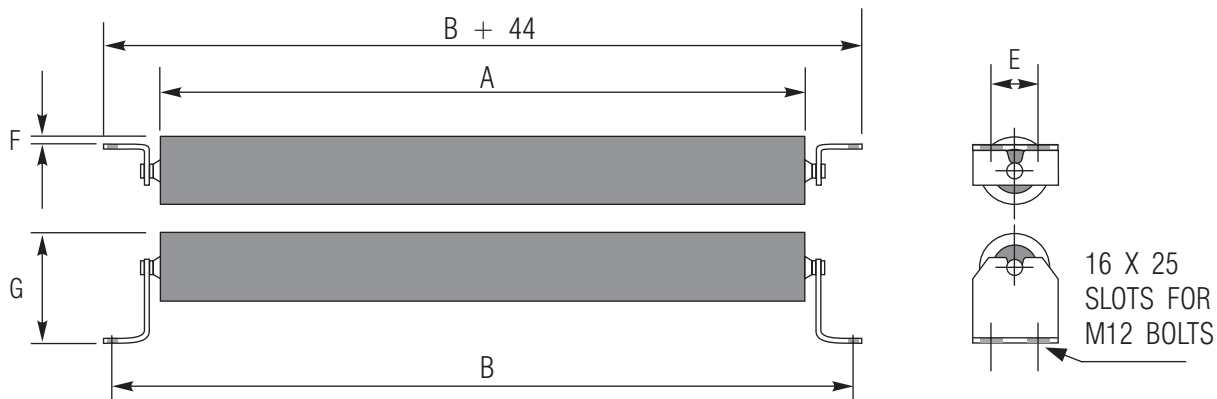

SERIES A25 62/82

ROLLER DIA.114

BEARING RATING 1430 kg

MAX. BELT SPEED 4.5 m/s

BELT WIDTH	IDLER DIMENSIONS mm					SHAFT DIA.
	A	B	E	F	G	
400	494	650	56	16	150	27
450	544	700	56	16	150	27
500	594	750	56	16	150	27
600	694	850	56	16	150	27
650	744	900	56	16	150	27
750	844	1000	56	16	150	27
800	894	1050	56	16	150	27
900	994	1150	56	16	150	27
1000	1094	1250	56	16	150	27
1050	1144	1300	56	16	150	30
1200	1294	1450	56	16	150	30
1350	1494	1650	56	16	150	33
1400	1544	1700	56	16	150	33

IDLER MASSES			
SETS		BRKT.	ROLL
MRP	TOTAL	PAIR	PLAIN
5.6	9.8	1.5	8.3
6.1	10.5	1.5	9.0
6.6	11.2	1.5	9.7
7.6	12.6	1.5	11.1
8.1	13.4	1.5	11.9
9.1	14.8	1.5	13.3
9.6	15.5	1.5	14.0
10.6	16.9	1.5	15.4
11.5	18.4	1.5	16.9
12.0	20.3	1.5	18.8
13.5	22.7	1.5	21.2
15.5	26.9	1.5	25.4
16.0	27.7	1.5	26.2

SERIES A30 62/82

ROLLER DIA.114

BEARING RATING 1980 kg

MAX. BELT SPEED 4.5 m/s

BELT WIDTH	IDLER DIMENSIONS mm					SHAFT DIA.
	A	B	E	F	G	
400	494	650	56	18	152	27
450	544	700	56	18	152	27
500	594	750	56	18	152	27
600	694	850	56	18	152	27
650	744	900	56	18	152	27
750	844	1000	56	18	152	27
800	894	1050	56	18	152	27
900	994	1150	56	18	152	27
1000	1094	1250	56	18	152	27
1050	1144	1300	56	18	152	30
1200	1294	1450	56	18	152	30
1350	1494	1650	56	18	152	33
1400	1544	1700	56	18	152	33
1500	1644	1800	56	18	152	36

IDLER MASSES			
SETS		BRKT.	ROLL
MRP	TOTAL	PAIR	PLAIN
5.9	11.1	1.5	9.6
6.4	11.9	1.5	10.4
6.9	12.7	1.5	11.2
7.9	14.4	1.5	12.9
8.4	15.2	1.5	13.7
9.4	16.8	1.5	15.3
9.8	17.6	1.5	16.1
10.8	19.2	1.5	17.7
11.8	20.8	1.5	19.3
12.3	21.6	1.5	20.1
13.8	24.0	1.5	22.5
15.7	27.3	1.5	25.8
16.2	28.1	1.5	26.6
17.2	32.5	1.5	31.0